

Sentinel Connector Systems Inc.

1953 Stanton Street

York, Pa. 17404

PART NO.: 111-080800B6LA4

- * EIGHT CONDUCTOR MODULAR PLUG
- * FOR CONDUCTORS WITH AN O.D. RANGE OF .037 / .042
- * USES .014 CONTACT
- * PRODUCT REQUIRES CONDUCTIVE LOAD BAR
- * FOR CAT 6 AND 6A PATCH CORD APPLICATIONS
- * USE FOR SOLID OR STRANDED WIRE APPLICATIONS
- * THIS PART ONLY COMES WITH FORWARD LOAD BAR

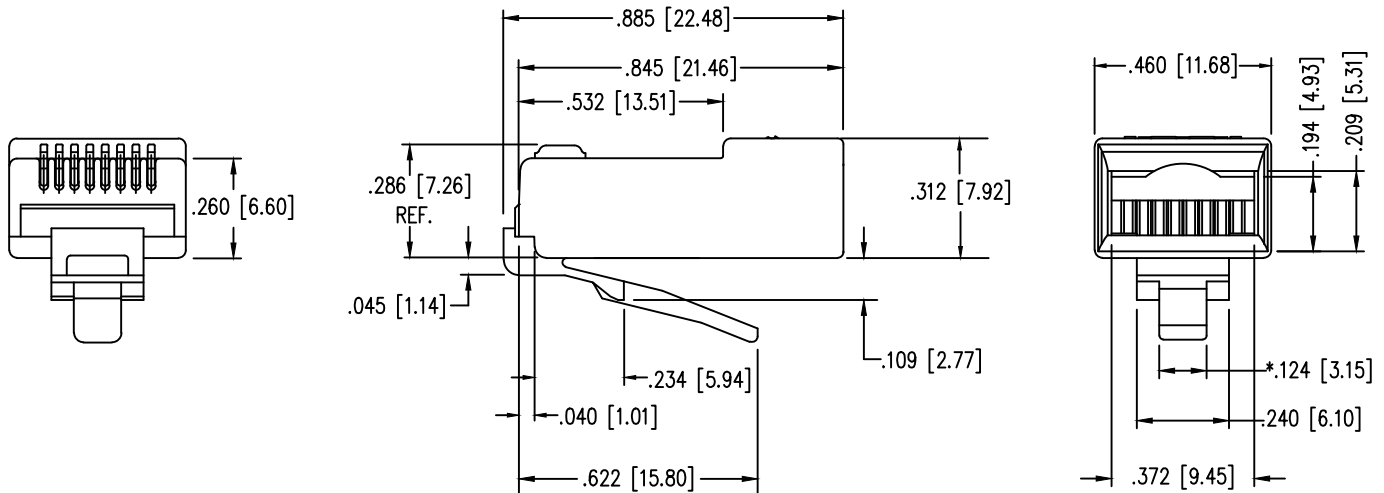
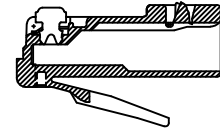
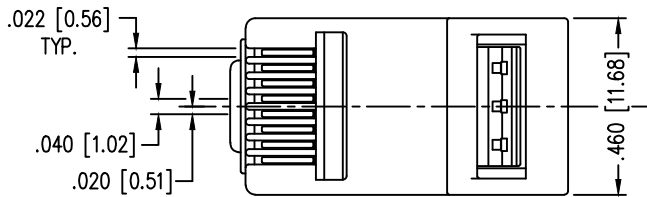
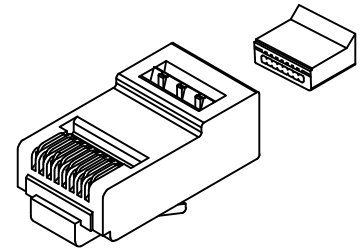

"PATENTED"

SPECIFICATIONS :

PERFORMANCE:

MEETS OR EXCEEDS CATEGORY 6 ANSI/EIA 568-C.2
PERFORMANCE TUNED TO CABLES MEETING CATEGORY 6 AND 6A PATCH CORD APPLICATIONS.

CONTACT MATERIAL:

PHOSPHOR BRONZE - .014 THK

CONTACT PLATING:

50 MICRO-INCH : OTHER PLATING OPTIONS AVAILABLE
SELECTIVE 24 CARAT HARD GOLD PLATE IN CONTACT AREA
OVER 100 MICRO-INCH MINIMUM NICKEL PLATE
PER CURRENT SELECTIVE GOLD PLATING REQUIREMENTS.

PLUG MATERIAL:

POLYCARBONATE

PLUG TOLERANCES

* COMPLIES WITH ANSI/TIA-1096-A REQUIREMENTS

AND DIMENSIONS:

U.L. RECOGNIZED

FLAME AUTO EXTINGUISH

OPERATION TEMPERATURE:

INSERTION/EXTRACTION LIFE:

CONTACT RESISTANCE:

CURRENT/VOLTAGE:

File# E188111

94-V0

-40°C TO +85°C

1000 CYCLES

10 MILLOHMS MAX.

30 VAC/57 VDC AT 1.5 AMPS

* FORMER COMPLIANCE, FCC PART 68.500

